

Computer-controlled folding machine



CAS 52/4/4/MS 45

**Set-up at the push of a button
thanks to automatic setting:**

- Automatic fold plate setting
- Semi-automatic fold roller setting
- 7 standard folds are pre-programmed
- Other folds are freely programmable
- Program memory for 60 repetitive jobs
- Automatic paper thickness measurement
- 4 fold plates in each fold unit
- Expandable to up to 3 fold units
- No calculating of stop positions
- No removal of fold plates
- No inserting of deflectors

multimaster CAS 52

The computer-control facilitates machine operation. All important settings are made at the push of a button by means of a dialogue display. After the type of fold has been entered, the fold plate stops move to the calculated position and the deflectors are engaged automatically. Fold roller setting does not require a special know-how either, because the computer calculates and displays the optimum roller gap on the basis of the measured paper thickness and the chosen type of fold.



Setting up saved jobs is even more convenient.

In addition to the positioning of fold plate

stops, sheet gap, speed, suction duration, shingled delivery and counting functions are also set. The optimum roller gap, including all individual corrections, is also determined by the control and therefore easily reproducible.

**Simple operation
Short set-up times
A minimum of waste**

Paper sizes:
max. 52 x 85 cm; min. 10 x 12 cm

Fold length:
max. 46.5 cm; min. 3.5 cm / 1.8 cm

Paper weight:
40 to 250 GMS

Speed:
200 m / min (depending on material)

Electrical:
3 x 400 V / 50 Hz / N / PE

Folding better automatically.

Increased benefit through optional equipment



MS 45

Mobile knife fold unit
Usable after 1st or 2nd fold unit
Knife rotates by 180°

Infeed width: max. 450 mm; min. 120 mm
Infeed length: max. 330 mm; min. 100 mm



KF 31

Attachable additional fold unit with two fold plates.
Especially for small folds

Infeed width up to 310 mm
Fold length: max. 110 mm; min. 18 mm



SKM 36

Small format vertical stacker
Prevents small folds from opening up

Infeed width: max. 360 mm; min. 50 mm

Gluing device



Cutting module

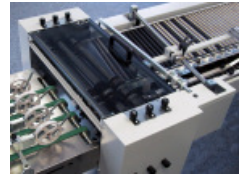

Timed perforation
and cutting



Scoring device for
digital printing

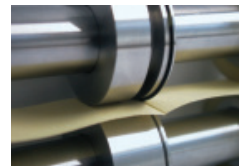

Two-up crossfold option



Plough fold



Reading device



Other machine versions

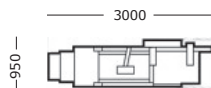

CAS 52/4/4

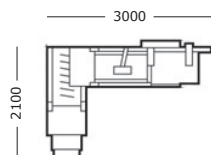

CAS 52/4/4/MS

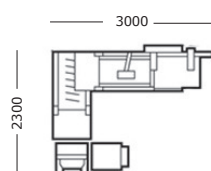

Folding better automatically.

Gate fold plate

Ionization bars

Kicker for delivery

Side trim device

Centre cut-out device

Scoring and
perforating tools

